



# ARDEX<sup>®</sup> PRODUCTS

2023 - 2024 Edition



111 NOTCH LANE WENDEL, PA 15691  
P: 800-245-5564 F: 724-446-9252  
[www.linttile.com](http://www.linttile.com)



# LINT TILE

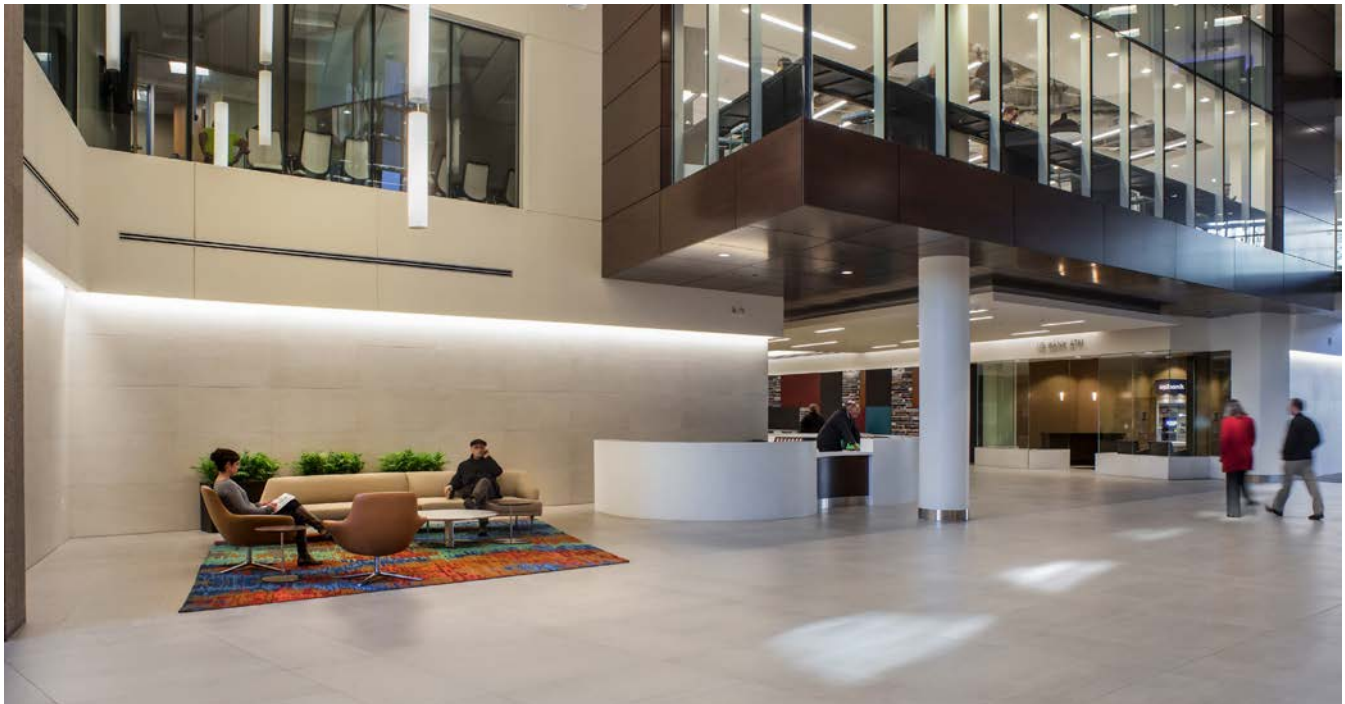

## OUR PARTNER

Recognized by installation experts, ARDEX Americas is the leading solution and service provider of innovative building systems. Ardex develops, manufactures and distributes high-performance specialty building products for all aspects of substrate preparation, floor covering, tile and stone installation systems and architectural concrete systems for commercial and residential applications. A family owned company, ARDEX leads through local customer interaction striving for excellence to ensure the job gets done to specification and on schedule, minimizing risk and costly callbacks.



# Table of Contents



WATERPROOFING.....3-4

MOISTURE MITIGATION.....5-6

PATCH.....7-8

PRIMERS.....9-10

SELF-LEVELING.....11-14

THINSETS & ADHESIVES.....15-20

GROUT.....21-22

UNCOUPLING & HEAT MEMBRANES.....23

THERMOSTATS & POWER MODULE.....24

ARDEX SHOWER SYSTEMS.....25-26

ARDEX DESIGNER SURFACES.....27-28





# WATER PROOFING



## ARDEX S 1-K™ SINGLE COMPONENT

Vendor Item #S 1-k - Style #AR-WAT S1K-07

- Flexible, topside waterproofing for interior floors and walls
- Use for bathrooms, showers and other wet areas
- Very easy-to-apply, 2-coat system- install with a roller or a brush
- Crack isolation up to 1/8" (3mm)
- Flood test in 12-24 hours
- Highly workable consistency; minimal drips and splatters

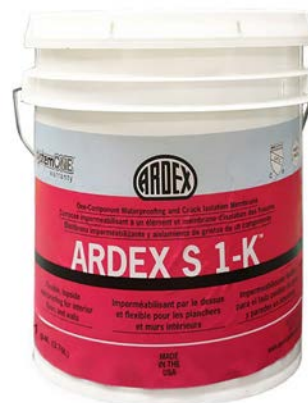

1 GAL/ALSO AVAILABLE 3.5 GAL

## ARDEX SK 175 SHEET MEMBRANE

Vendor Item #SK 175 - Style #AR-WAT SK175-L  
#AR-WAT SK175-S: 108 SQ FT

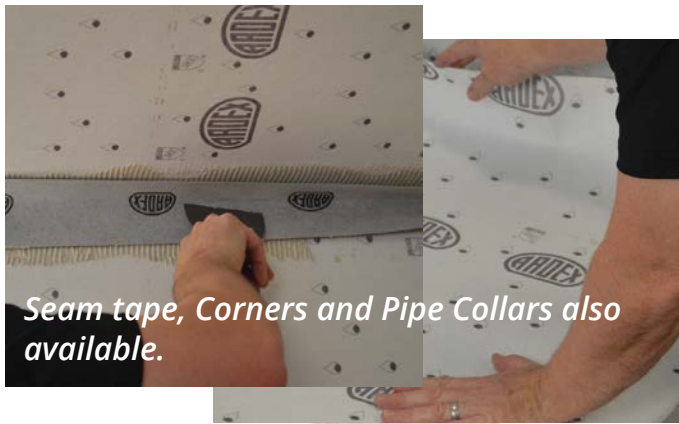

Seam tape, Corners and Pipe Collars also available.

Waterproofing Membrane 39" wide x 98' long  
(1 m wide x 30 m long) roll

Waterproofing Membrane 39" wide x 33' long  
(1 m wide x 10 m long) roll



323 SQ FT ROLL /ALSO AVAILABLE IN 108 SQ FT ROLL

ARDEX SK 175 is a pliable, sheet-applied, bonded waterproof membrane and vapor retarder constructed of polyethylene. Its high-performance fleece webbing securely bonds the membrane using ARDEX mortars prior to the installation of tile or stone in areas requiring topside waterproofing and enhanced vapor protection. Tile can be installed directly onto ARDEX SK 175.

- Flood test 24hrs after installation
- For topside waterproofing over loors and walls
- Very low perm rating acceptable for residential and commercial steam showers (.04)
- Interior or exterior use
- Ideal for swimming pools; just one layer required
- Also for use on balconies and terraces

## ARDEX 8+9™ 2 COMPONENT RAPID

Vendor Item #8+9- Style #AR-WAT 8-9-1GR  
#AR-WAT 8-9-1WH

### Rapid Waterproofing & Crack Isolation Compound

Two-component, solvent-free, Portland cement and acrylic-based liquid system that produces a flexible waterproof coating to protect substrates from topside side water infiltration. ARDEX 8+9 provides an outstanding bonding layer for ARDEX tile and stone setting materials.

- Ideal for commercial or residential showers, bathrooms and kitchens
- Gray or White
- Cement on cement for a stronger bond
- Rapid setting tile in as little as 90 minutes
- Crack isolation up to 1/8" (3mm)
- 1/3 less cost per sqft than the competitors' products
- Coverage- 100 sqft/unit (conv kit)  
Convenient kit: 1 gallon (3.78 L)  
ARDEX 8 / 9 lb. (4 kg) ARDEX 9
- Flood test in 4hrs after 2 coats
- Pot life 45 mins



1 GAL / CONVENIENT KIT



# MOISTURE MITIGATION



## ARDEX MC RAPID MOISTURE CONTROL

Vendor Item #MC™ RAPID



22 LBS

### One-Coat Moisture Control System for Concrete Receiving ARDEX Underlayments

*The ARDEX MC™ RAPID Moisture Control System is formulated to suppress excessive moisture vapor emissions in new or existing concrete prior to installing an ARDEX underlayment with flooring. It is especially suited to critical installations where the construction schedule does not allow adequate drying of concrete.*

- 100% Solids Epoxy Resin System
- No sand broadcast required for underlayment applications of 1/4" (6mm) or less
- Working time: 20 minutes
- Walkable in 4 hrs
- Prime and install underlayment in 4hrs
- Tenacious bond to substrate

## ARDEX VR 98™ VAPOR RETARDER

Vendor Item #VR 98- Style #AR-MC VR-98

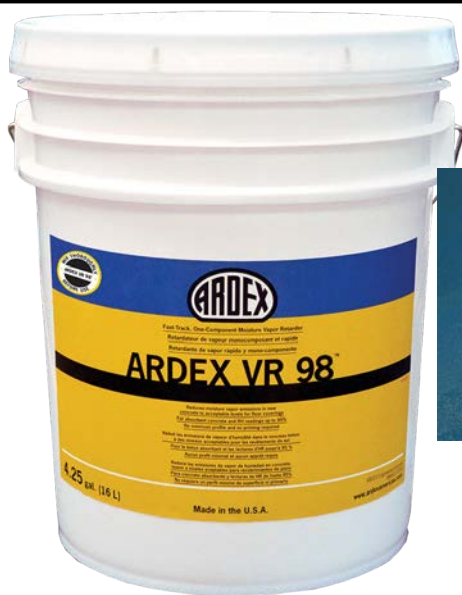

### Fast-Track, 1 Component Moisture Vapor Retarder

ARDEX VR 98™ is a ready-to-use, one-component, water-based, two-coat system formulated to suppress residual moisture in concrete with RH readings up to 98%. ARDEX underlayments may be installed over the second coat in as little as 2 hours without priming. ARDEX VR 98 comes in a ready-to-use, resealable container. It is pigmented blue to help indicate uniform coverage for ease of application.

- Protects the final floor covering installation
- Suppresses residual moisture in concrete
- For RH readings up to 98%
- On/below grade slabs when an intact structural vapor barrier membrane is present
- One component- no parts to mix
- No floor profile is required
- Dries in 30 minutes- takes underlayment in 2hrs
- No primer needed

4.25 GAL

## ARDEX VB 100™ NO PRIMER VAPOR BARRIER

Vendor Item #VB 100



### Fast-Track, 1-Component Moisture Vapor Barrier

ARDEX VB 100™ is a ready-to-use, one-component, water-based, two-coat system formulated to suppress excessive moisture in concrete. ARDEX underlayments may be installed over the second coat in as little as 60 minutes without priming. ARDEX VB 100 comes in a ready-to-use, resealable container.

- For absorbent concrete
- For floor coverings
- Reduces moisture vapor emissions in concrete to acceptable levels
- For RH readings up to 100%
- Easy to use, apply & resealable
- One component- no parts to mix
- No minimum profile is required
- Dries fast- takes underlayment in as little as 1hr
- No priming required prior to installation of Ardex underlayments

5 GAL



# PATCH

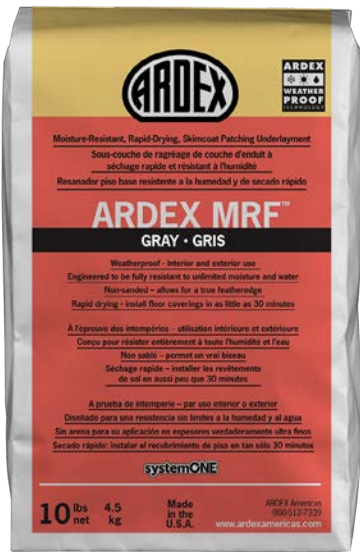

## ARDEX MRF™

Vendor Item #MRF- Style #AR-LEV MRF

### Moisture-Resistant, Rapid-Drying, Skimcoat Patching Underlayment

*Ideal for patching & skimcoating under moisture control systems, and moisture resistant adhesives and flooring!*

- Weatherproof- Interior & Exterior Use
- Engineered to withstand 100% RH; unlimited moisture and water
- Non-sanded- Allows for a true feather edge
- Rapid drying- Install floor coverings in as little as 30 minutes
- Interior- Install up to 1/2" or unlimited depth in small areas
- Exterior- Install as a skim coat over large areas and up to 1/4" in small areas

10 LBS

## ARDEX FORTI FINISH™

Vendor Item #FORTI FINISH- Style #AR-LEV FORTI

- Installs over concrete & prepared adhesive residues on concrete
- Polymer-modified
- Self-drying matrix
- Mixes with water (only)
- Trowelable
- Interior use
- Covers 40 sqft per bag at 1/16"
- Pot life- 15 to 20 minutes
- No priming required



### High Strength Self-Drying Finish Underlayment

*ARDEX FORTI FINISH™ is a cement-based underlayment developed specifically for challenging environments such as hospitals where heavy rolling loads and high point loads are common. ARDEX FORTI FINISH will not contribute to mold, mildew and staining of floor covering.*

10 LBS





10 LBS

## ARDEX SKM™

Vendor Item #SKM- Style #AR-LEV SKM-GR

### Skimcoat Patch and Finishing Underlayment

*ARDEX SKM™ can be used over interior concrete, wood, ceramic or quarry tile, cutback and other non-water soluble adhesive residues. ARDEX SKM delivers a permanent, smooth, durable finish prior to the installation of floor coverings. ARDEX SKM hardens quickly, is very easy to apply and dries fast without shrinkage.*

- Coverage- 150 - 200 sqft as a skim coat
- Easily sanded
- Non-sanded- Allows for a true feather edge
- Rapid drying- Install floor coverings in as little as 30 minutes
- Interior use- Featheredge up to 1/2" (12mm)
- No priming required

## ARDEX SD-P™

Vendor Item #SD-P

### Self-Drying, Trowelable Concrete Underlayment

*Fast setting patch for smoothing and repairing concrete floors, ramps and stairways, as well as non-porous substrates such as terrazzo, ceramic and quarry tile, prior to the installation of floor covering. Special blend of portland cement, hydraulic cements and polymers.*

- Coverage- 50 ft<sup>2</sup> per bag at 1/8" (4.6 m<sup>2</sup> at 3 mm)
- For ramping, patching large areas and screeding
- Mixes with water only
- Rapid setting
- Exceptional bond strength
- No priming required over standard absorbent concrete



40 LBS

### General Patch & Skimcoat

*Suited for skim coating prior to installing finished floor. Hardens quickly without shrinking.*

- Coverage- 700 - 800 ft<sup>2</sup> per bag at a skim coat
- Install over a variety of interior surfaces
- Portland cement based, trowelable
- Rapid setting- Potlife 15 mins, walkable 30 mins
- Floor coverings may be installed in 1 - 2 hrs
- May be used as an embossing leveler

25 LBS

## ARDEX GPS™

Vendor Item #GPS- Style #AR-LEV GPS



ORDERS: 800-245-5564 - CREDIT APPLICATIONS: [www.linttile.com/forms](http://www.linttile.com/forms)



# PRIMERS

## ARDEX P 4™ PREMIXED PRIMER

Vendor Item #P 4- Style #AR-LEV P4-1G,  
#AR-LEV P4-3.5G

**Pre-Mixed, Rapid-Drying, Multipurpose Primer**  
ARDEX P 4™ is a pre-mixed, single-component, rapid-drying, multi-purpose primer. Ideal for use over porcelain, ceramic, most natural stone tile as well as over concrete, cementitious or epoxy terrazzo and cement screeds. For use prior to the installation of ARDEX Tile & Stone Installation Systems and most ARDEX Self-Leveling Underlayments.

- Coverage- 1 gal. (3.79 L) unit: 300 sq. ft. (27.8 sq. m)
- Ideal for Tile over Tile installation
- Textured surface for tenacious bond
- Rapid setting- Dries in as little as 30 mins
- Drip and splash free consistency
- Interior and exterior use



1 GAL OR 3.5 GAL

## Substrate Preparation Epoxy Primer

ARDEX EP 2000™ is a two-component, 100% solids epoxy resin primer formulated for use with ARDEX Underlayments and Toppings. It is especially suited to prime concrete and other structurally sound and solid substrates. Install over: terrazzo, epoxy coatings and ceramic and quarry tile, prior to installing ARDEX products.

- Coverage- 150 to 200 sq. ft. (13.9 to 18.2 m<sup>2</sup>)
- Interior or Exterior
- Walkable 6 hrs after sand broadcast
- Install underlayment 16hrs after sand broadcast
- Required primer for all toppings
- Can provide secondary top-down waterproofing
- Can be used as crack filling material
- Receives sand broadcast
- Low viscosity & solvent-free

## ARDEX EP 2000™ 2 PT EPOXY PRIMER

Vendor Item #EP 2000



10 LBS



*Improves the adhesion of ARDEX products. Install over: standard absorbent dry concrete substrates and other substrates in specialized applications; over wood use ARDEX GS-4™ or ARDEX Liquid Backer-Board®. Non-porous substrates must be primed with ARDEX P 82™ Ultra Prime.*

- Packaging: 1 gallon (3.79 L) plastic bottle/ Also available in 4 gallon (15.14 L) plastic pail.
- Coverage: 400 to 600 sq. ft. per gallon (37 to 55 m<sup>2</sup>)
- Dry time: 3 to 24 hrs.
- Concentrated Primer - dilute with water.
- Solvent free
- Interior use
- Seals the substrate
- Also for use on balconies and terraces

1 GAL /ALSO AVAILABLE IN 4 GAL

## ARDEX P 51™ PRIMER

Vendor Item #P 51 - Style #AR-LEV P51-PR

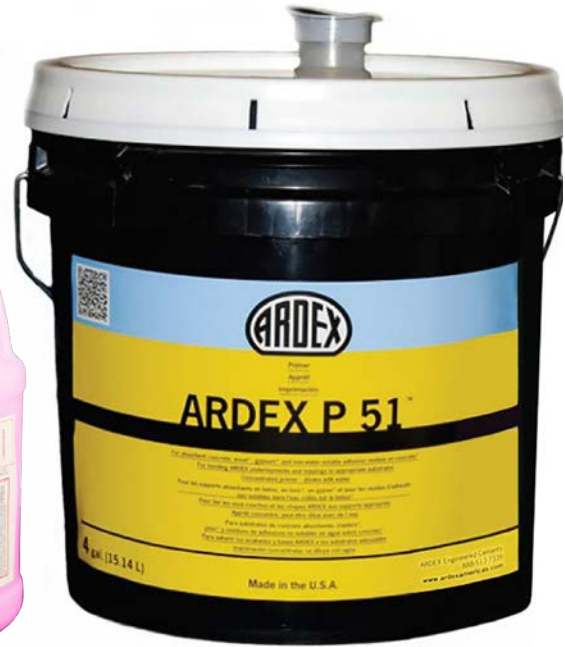

## ARDEX P 82™ 2 COMPONENT PRIMER

Vendor Item #P 82- Style #AR-LEV P82-PR

*Improves the adhesion of ARDEX products. Install over: smooth, non-absorbent substrates such as ceramic and other stone tiles, terrazzo, epoxy and metal decking; ARDEX P 82 is also used over wooden subfloors, including plywood and strip wood, as well as over cutback and other non-water-soluble adhesive residues.*

- Waterbourne 2 Component Primer for interior use
- Solvent free
- Seals substrate
- Packaging- 2 1/2 GAL containers
- Dry time- 3 to 24 hrs
- Coverage- Varies from 300 to 600 sqft according to how porous the substrate



2 (1/2 GAL) CONTAINERS



# SELF - LEVELING



50 LBS

## ARDEX K 40™ RAPID

Vendor Item #K 40 RAPID

### Rapid, High Flow Self- Leveling Underlayment

Use to level and smooth interior concrete, terrazzo, ceramic and quarry tile, epoxy coating systems and non-water-soluble adhesive residue on concrete.

- Coverage- 1 gal. (3.79 L) unit: 300 sq. ft. (27.8 sq. m)
- Levels from 1/8" (3 mm) up to 1" (24 mm) thick
- Dry Interior use only
- Rapid dry technology - Install most flooring in as little as 2 hours

## ARDEX K 60™ ARDITEX

Vendor Item #K 60- Style #AR-LEV K60,  
#AR-LEV K60-LIQ



### Rapid Setting Latex Smoothing and Leveling Compound

ARDEX K 60™ ARDITEX is a blend of Portland cement and other hydraulic cements that is a self-smoothing, trowelable, latex leveling compound with excellent adhesion, flexibility and moisture resistance. ARDEX K 60 can be used to smooth interior concrete, wood, terrazzo, ceramic and quarry tile, steel, select epoxy coating systems and non-water-soluble adhesive residue on concrete prior to the installation of finished flooring on-, above- or below-grade.

- Use to level and smooth interior concrete, wood, terrazzo, ceramic and quarry tile, steel, select epoxy coating systems and non-water-soluble adhesive residue on concrete
- A blend of Portland cement and other hydraulic cements
- No water required for mixing; simply mix with latex additive
- No mechanical profiling required (except steel substrates; see below)
- No priming required (except non-ARDEX epoxy substrates; see below)
- Trowelable and can smooth floors at 1/8" (3 mm) or less
- Walkable in 2-3 hours
- Suitable for use under ARDEX MC™ Moisture Control Systems
- Interior use only

35 LBS MIX / ALSO AVAILABLE 1 GAL

## Self-Leveling Underlayment for Interior Wood and Concrete Subfloors



50 LBS

## ARDEX LIQUID BACKERBOARD®

Vendor Item #LIQUID BACKERBOARD-  
Style #AR-LEV LIQ

*The Ultimate Smooth, Flat Surface for Tile Installations. Pourable, Portland cement-based material that replaces backer board for a faster, easier, seamless installation eliminating the need to cut, fit, glue and fasten.*

- No metal lath required
- One bag covers = 3 sheets of backer board
- For use over wooden subfloors, concrete, terrazzo, ceramic tile and epoxy
- Mixes with just water, no additives required
- Ideal over in-floor heating
- Now approved for prefilling ARDEX UI 740TM FLEXBONE®

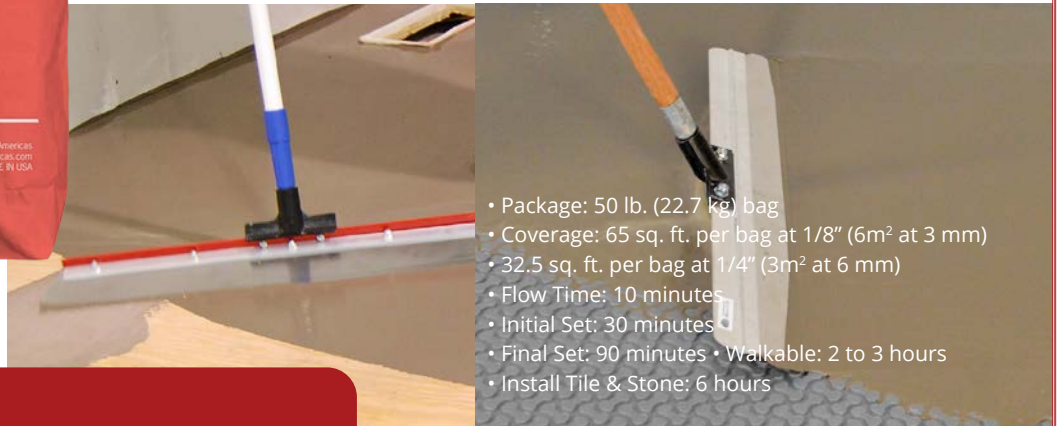

- Package: 50 lb. (22.7 kg) bag
- Coverage: 65 sq. ft. per bag at 1/8" (6m<sup>2</sup> at 3 mm)
- 32.5 sq. ft. per bag at 1/4" (3m<sup>2</sup> at 6 mm)
- Flow Time: 10 minutes
- Initial Set: 30 minutes
- Final Set: 90 minutes • Walkable: 2 to 3 hours
- Install Tile & Stone: 6 hours

## ARDEX TL 2000™

Vendor Item #TL 2000- Style #AR-LEV TL2000

### Fiber Reinforced, Self-Leveling Underlayment

*ARDEX TL 2000™ Fiber Reinforced, Self-Leveling Underlayment is a blend of high-strength gypsum, Portland cements, polymers and high performance fibers used to smooth existing above-grade floors prior to the installation of tile, stone and other new floor coverings.*

- Easy to mix and apply; high flow material
- No lath mesh or additives required over wood substrates
- Provides a smooth, flat surface optimal for installing large format tile and stone over wood, concrete, gypsum, VCT, porcelain tile, existing patch or leveling materials and non-water-soluble adhesive residue on concrete
- Interior, above-grade floors only
- Installs up to 1 1/4" (3 cm) thick neat and up to 2" (5 cm) with aggregate
- Walkable in 2 - 3 hours
- Install tile or stone and all other floor coverings in as little as 24 hours



50 LBS



## Self-Leveling Underlayment

**ARDEX TL 1000™ is a self-leveling underlayment formulated with a blend of Portland cement, other hydraulic cements and polymers. ARDEX TL 1000 is designed specifically for fast leveling of interior concrete, cementitious terrazzo or ceramic, quarry or porcelain tiles prior to installing flooring – on, above or below grade. It can even be installed over concrete treated with certain curing compounds. Pourable or pumpable when mixed with water, ARDEX TL 1000 seeks its own level and produces a durable, smooth and flat floor surface with minimum labor.**

- Formulated specifically for fast leveling of floors prior to installing tile or stone
- Ideal for large and super-format tile installations
- Level and smooth new or existing concrete; cementitious terrazzo; ceramic, quarry or porcelain tiles
- Install up to 11/4" (3 cm) neat
- Can be tapered to meet existing elevations
- Walk on in 4 -5 hours
- Install most tile or stone\* in just 6 hours and most other floor coverings after 24 hours
- Easy to mix with just water - no additives required
- For interior use only

50 LBS

## ARDEX TL 1000™

Vendor Item #TL 1000- Style #AR-LEV TL1000



## ARDEX TL 1400™

Vendor Item #TL 1400- Style #AR-LEV TL1400



## Self-Leveling Underlayment

**ARDEX TL 1400™ is a blend of Portland cements, hydraulic cements and specialty polymers formulated to smooth substrates prior to installing tile and other floor coverings on, above and below grade. ARDEX TL 1400 is easy to mix with just water resulting in a pourable and pumpable material that finds its own level and delivers a flat, durable surface that is especially suited for large and super format tile and stone installations, as well as most other types of floor coverings.**

- For smoothing substrates prior to tiling over interior concrete, terrazzo, tile, epoxy coatings and non-water-soluble adhesive residue over concrete
- Installs up to 11/4" (3 cm) neat
- Can be tapered to meet existing elevations
- Walk on in 2 to 3 hours; Install tile in 6 hours
- Interior use only

50 LBS



## Self-Leveling Flooring Underlayment

**ARDEX LU 100™ Self-Leveling Underlayment is a blend of high strength cements and powdered polymers used to repair existing above-grade floors prior to the installation of new floor coverings.**

- A blend of high strength cements and powdered polymers
- Pourable with the ROVER® Rolling Barrel Cart &
- Pumpable with the AMP® Automatic Mixing Pumps
- Low shrinkage
- Mixes with water
- Use over concrete, wood, VCT, existing patching and leveling materials and non-water-soluble adhesive residue on concrete
- Use for interior, above-grade floors only
- Install up to 2" (5 cm) neat and up to 5" (12 cm) with aggregate
- Walkable in 3 hours
- Install floor coverings in as little as 2 - 3 days

50 LBS

## ARDEX LU 100™

Vendor Item #LU 100



## ARDEX AM 100™ RAMPING MORTAR

Vendor Item #AM 100- Style #AR-MTR AM100

**ARDEX AM 100™ is a unique smoothing and ramping mortar for vertical and horizontal concrete and masonry surfaces that significantly reduces the preparation time prior to the installation of all types of tile and stone. It can also be used to slope balconies and create slope to drains. ARDEX AM 100 is ideal for fast-track tiling applications in wet areas for the smoothing of swimming pools, showers, fountains and below-grade installations, such as subway stations.**

- Smooth concrete and masonry surfaces prior to tiling
- Install tile in just 2 hours
- Water and frost resistant
- Place from 1/4" to 11/4" in one coat
- Use to smooth walls and floors
- Especially suited for re-sloping balconies and sloping to drains
- Interior and exterior
- No sag or slump
- Excellent bond strength
- Ideal for swimming pools, for smoothing of walls in underground transportation areas and other wet or damp areas

## Rapid Set Pre-Tile Smoothing and Ramping Mortar



40 LBS



# THINSETS & ADHESIVES



*ARDEX X 3™ PLUS is a polymer-modified, mortar for setting quarry, ceramic and most natural stone tiles over common interior surfaces, including exterior-grade plywood, as well as over exterior concrete and masonry surfaces.*

## ARDEX X 3™ PLUS

**Vendor Item #X 3 PLUS- Style #AR-MTR X3P-WH**

### LHT - Large and Heavy Tile and Stone Mortar

- Formulated for large tile and stone at ungauged thicknesses
- For setting porcelain, quarry, ceramic and most natural stone tiles
- Use with uncoupling and anti-fracture membranes
- For thicker bond coats: 3/32" to 1/2" (2.5 mm to 12 mm)
- Non-sag – for use on walls and floor
- Minimizes slump
- Easy to apply creamy consistency- 3hr potlife
- Interior and exterior use

40 LBS

## ARDEX X 4™

**Vendor Item #X 4 LFT- Style #AR-MTR X4-GR  
#AR-MTR X4-WH**

### LFT - Large Format Tile and Stone Mortar

- Ideal for large format tile and stone
- Use for setting porcelain, quarry, ceramic and most natural stone (moisture insensitive) tiles
- Use above and below uncoupling membranes
- Easy to mix and apply
- 3-hour pot life
- Interior or exterior use; water and frost resistant

*ARDEX X 4™ is a polymer modified mortar for setting most types of tile including mosaics and natural stone\* over common interior surfaces including exterior grade plywood, as well as over exterior concrete and masonry surfaces. ARDEX X 4 mortar can be used to set porcelain tiles on horizontal exterior concrete or masonry surfaces.*



40 LBS



*ARDEX X 5™ is a highly versatile, polymer-modified, large format and heavy tile and stone mortar for setting porcelain, quarry, ceramic and most natural stone\* tile over common interior surfaces, including exterior-grade plywood, as well as exterior concrete and masonry surfaces.*

40 LBS

## ARDEX X 5™

Vendor Item #X 5- Style #AR-MTR X5-GR  
#AR-MTR X5-WH

### Flexible and Versatile Tile and Stone Mortar

- For large format and heavy tile and stone applications up to 3/4" sq. notch trowel
- For setting porcelain, quarry, ceramic and most natural stone tile
- Excellent sag resistance
- Very creamy, easy to apply
- 3-hour pot life
- Interior and exterior use; water and frost resistant

## ARDEX X 65™ LITE

Vendor Item #X65 LITE

### Lightweight Universal Tile and Stone Mortar

- Versatile, high-performance lightweight mortar (30 lb. bag) delivering equal or better coverage than competitive 50 lb. bags
- Easy to apply, creamy consistency, non-sag, 3-hour pot life
- Use for setting porcelain, quarry, ceramic and most natural stone (moisture insensitive) tiles
- For large-format and large heavy tile
- Water & frost resistant - for swimming pools\* and high traffic areas
- Interior and exterior applications

*ARDEX X 65™ Lite is a versatile, high-performance lightweight mortar (30 lb. bag) delivering equal or better coverage than competitive 50 lb. bags. The easy-to-apply, creamy consistency is sag resistant and ideal for setting large format and heavy tile. ARDEX X 65 Lite can be used for setting porcelain, quarry, ceramic and most natural stone tiles.*



30 LBS



*ARDEX X 77™ MICROTEC® Fiber Reinforced Tile and Stone Mortar is a high-performance, microfiber-reinforced, polymer-modified mortar formulated especially for large format tile installations. Install porcelain, glass, quarry, ceramic or most natural stone tiles over interior or exterior concrete floor and wall surfaces. Use for interior applications over exterior-grade plywood. Ideal for use in swimming pools and fountains and over in-floor heating systems and is recommended for all tile sizes, including mosaics.*

40 LBS

## ARDEX X 77™

Vendor Item #X 77- Style #AR-MTR X77-GR,  
AR-MTR X77-WH

### Fiber Reinforced Tile and Stone Mortar

- Ideal for large format tiles.
- Extended open time of 60 minutes
- Outstanding coverage - 110 sq. ft. per bag with 1/4" sq. notch trowel
- Medium bed applications (large tile mortar)
- Water, frost and sag resistant
- Highly flexible; 3-hour pot life





## ARDEX X 78™

Vendor Item #X 78- Style #AR-MTR X78-GR,  
AR-MTR X78-WH

### Semi-Pourable Tile and Stone Mortar

- For setting porcelain, glass, quarry, ceramic, mosaics and most natural stone tiles
- Use over exterior concrete and masonry surfaces, as well as over common interior surfaces, including exterior grade plywood
- Extended open time of up to 60 minutes, 4 hour pot life
- Especially suited for large format tile installations
- Very high bond strength, highly flexible for excellent shear resistance
- Unique, semi-pourable consistency makes it extremely easy to mix and apply
- Ideal for high traffic areas
- Special additives virtually eliminate the risk of efflorescence
- Use for interior and exterior floors and horizontal surfaces
- Outstanding coverage - 105 sq. ft. (9.75 sq. m) per bag with 1/4" Sq. notch trowel

**ARDEX X 78™ MICROTEC®**  
*Semi-Pourable Tile and Stone Mortar is formulated to provide high bond strength and flexibility, making it ideal for the installation of large format tiles in high traffic areas. Its unique, semi-pourable consistency makes application over large areas fast and easy. Also, it provides excellent contact upon setting eliminating the need to back butter the tile in most instances.*



40 LBS



**ARDEX X 7 R™** is a versatile, easy-to-apply, polymer-modified tile and stone mortar with advanced properties of adhesion and flexibility. It is an ideal, everyday, fast-track solution for setting porcelain, quarry, ceramic, mosaic and most natural stone tiles\* in interior or exterior floor and wall applications. **ARDEX X 7 R is rapid-setting and allows for grouting in just three hours.**

40 LBS

## ARDEX X 7 R™

Vendor Item #X 7 R- Style #AR-MTR X7-RGR

### Rapid Set, Flexible Tile and Stone Mortar

- Rapid-set - walk on or grout in just 3 hours
- Polymer-modified mortar for setting porcelain, quarry, ceramic, and most natural stone\* tiles
- Very good sag resistance
- Easy to apply creamy consistency
- Interior and exterior use
- 30 - 45 minute pot life
- Suitable for use with in-floor heating systems
- Suitable for use in wet areas, including showers, swimming pools, etc.

## ARDEX FB 9 L

Vendor Item #FB 9 L- Style #AR-MTR FB9L-GR

### Pourable ShearFlex® Mortar

- Mix with water only
- Interior and exterior
- Water and frost resistant
- No back buttering
- Easy to mix and apply
- Use with in-floor heating systems
- Use to install SCHLUTER® DITRA® Mat

*A specially designed Portland cement based, polymer modified mortar for the easy installation of large format floor tile on horizontal surfaces. The unique, pourable consistency of ARDEX FB 9 L provides full coverage with high bond strength and flexibility without the need to back butter.*



40 LBS



**ARDEX N 23** is a rapid-setting, thin-to-medium-bed mortar that is ideal for interior installations of moisture-sensitive natural stone, marble, granite, porcelain, quarry and ceramic on horizontal or vertical surfaces. Recommended for all tile sizes and concrete floors with in-floor heating systems. **ARDEX N 23** has proprietary self-drying technology to prevent staining, discoloration, warping and efflorescence, excellent bond strength, sag resistance, an open time of up to 30 minutes and a 60-minute pot life.

40 LBS

## ARDEX N 23™

Vendor Item #N 23

### Rapid Set Natural Stone and Tile Mortar

- Use for setting porcelain, quarry and ceramic tile, ungauged stone, translucent marble, glass and natural stone tile
- Fast setting - grout in two hours
- Ideal for moisture-sensitive natural stone tile
- Self-drying technology - will not contribute to staining, warping or efflorescence
- Outstanding coverage - 103 sq. ft. (9.5 sq. m) per bag with 1/4" sq. notch trowel
- Thin- to medium-bed installation up to 5/8" (15 mm)
- 1-hour pot life
- Use for interior floors and walls
- Extended open time of 30 minutes
- Excellent bond strength and sag resistance

## ARDEX S 48™

Vendor Item #S 48

### Rapid-Set Mortar / Mastic Hybrid

- Ideal for fast setting of glass tiles and backsplashes
- Grout in just 1 to 5 hours; install tile and grout in the same day
- Excellent for quick tile repairs and fixes

**ARDEX S 48™ Rapid-Set Mortar / Mastic Hybrid** is the most versatile tile setting material available for interior tile applications. A rapid setting polymer-modified, Portland cement based mortar that is ideal for fast-track installations of glass tile and back splashes. Use with porcelain, glass, ceramic, quarry, mosaics or most natural stone tile over all common substrates. Suitable for intermittent wet areas including residential bathrooms and kitchens. Its creamy, smooth consistency is similar to a pre-mixed mastic.



10 LBS





*A rapid-setting, Portland cement-based, polymer-modified mortar with MICROTEC® and self-drying technologies, ARDEX X 32™ MICROTEC® Universal Rapid Setting and Drying Thin-to-Thick Bed Mortar is ideal for moisture-sensitive natural stone, marble and granite installations. Excellent for use with agglomerate and ungauged stones that require various mortar depths. Ready for grout in 3 hours. Ideal for same day interior or exterior fast track installations. Use over concrete, masonry and exterior-grade plywood.*

40 LBS

## ARDEX X 32™

Vendor Item #X 32

### Rapid Set Natural Stone and Tile Mortar

- Fast setting - walk on and grout in 3 hours
- Use as a thin, medium or thick bed mortar, up to 11/4" (32 mm)
- Ideal for use with moisture-sensitive stone, virtually eliminates staining, warping and discoloration
- Water repellent; for fast track swimming pool and wet area applications
- The ultimate mortar for interior and exterior ungauged stone applications
- Ideal for use with heavy and large format tiles
- Excellent sag resistance for walls and slump resistance for floors
- Easy to mix and apply; mixes using just water
- Ideal for rapid pre-smoothing of floors and walls prior to tiling

## ARDEX X 90 OUTDOOR™

Vendor Item #X 90- Style #AR-MTR X90-GR

### Microtec3 Rapid-Set Flexible Tile and Stone Mortar

- Ideal for tiling on concrete balconies, patios, swimming pools and high-load commercial areas
- Traffic and grout after just 2 hours
- Thin to medium bed installations up to 5/8" (15 mm)
- Extended open time up to 30 minutes
- Excellent bond strength for setting porcelain, glass, ceramic and most natural stone tiles
- Very creamy, easy-to-apply consistency
- Extra long pot life of 60 minutes
- For exterior or interior floors and wall

*ARDEX X 90 OUTDOOR™ is a revolutionary innovation in mortar technology that is formulated with specialty, high-performance ARDEX cements, polymers and microfibers to deliver maximum protection against the harshest weather conditions and provide the highest levels of efflorescence resistance for exterior tile and stone applications. Installs over substrates with temperatures as low as 40 °F (5 °C) and can withstand driving rains or be grouted in only 2 hours.*



40 LBS



## ARDEX D 14™

Vendor Item #D 14- Style #AR-ADH D14-3G,  
AR-ADH D14-1G

### Type 1 Premixed Tile Adhesive (Mastic)

- Use for setting quarry, ceramic, mosaic and moisture-insensitive stone tile
- Also sets porcelain tile over absorbent surfaces
- Use for interior walls, floors, and countertops
- Use to install tile in tub surround applications
- Easy to use and apply
- Good sag resistance
- Hangs up to 12" x 12" tile

ARDEX D 14™ is a TYPE 1 pre-mixed tile adhesive that is ideal for setting quarry, ceramic, mosaic and most natural stone tile over interior surfaces. Also, it can be used to set porcelain tile over absorbent interior surfaces. Use over interior concrete block, drywall, plaster, brick and existing tile. Can be used for tub surrounds and in intermittent wet areas.



3.5 GAL, 1 GAL

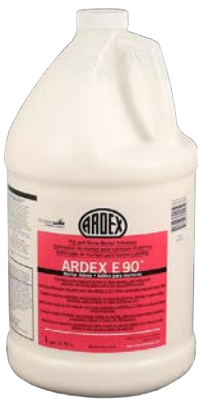

ARDEX E 90™ Mortar Admix is a synthetic additive for use with select ARDEX tile and stone mortars. ARDEX E 90 is diluted with water prior to mixing with mortars. The addition of ARDEX E 90 results in a mortar that, once set and hardened, has high bond strength, excellent elastic and water-repellent properties. ARDEX E 90 is ideal for internal and external tile and stone installations.

1 GAL

## ARDEX E 90™

Vendor Item #E 90

### Tile and Stone Mortar Enhancer

- For use with select ARDEX tile and stone mortars
- Improves adhesion and flexibility when setting all tile types
- Achieves ISO 13007 S2 deformability when with ARDEX X 77, X 78, S 28 & N 23
- For interior or exterior use
- Provides a water-repellant mortar for tiling showers, swimming pools and other wet areas; helps reduce the risk of efflorescence
- Ideal for setting glass tile when used with ARDEX X 77 White along swimming pool water lines
- Allows direct tile installation over existing tiles without profiling or priming
- Suitable for use over in-floor heating systems

## ARDEX CA 20 P™

Vendor Item #CA 20 P- Style #AR-ADH CA20P

### Multipurpose Construction Adhesive and Sealant

- Extremely versatile - Bonds a wide range of materials including glass, metal, wood, ceramics and plastic. Ideal for minor repair applications, even under water
- Available in white. High bond strength
- Use to fill movement joints. Interior and exterior walls and floors
- Highly flexible. Neutral curing system - Free of solvents, water and isocyanates
- Can be painted
- Shrinkage free drying
- Zero VOC content
- Single component modified silane polymer

ARDEX CA 20 P™ is a one-component, modified silane, polymer adhesive and neutral curing sealant that hardens in reaction with moisture. ARDEX CA 20 P is extremely flexible with excellent bond strength. Ideal for replacing tiles or for use as a general shower, kitchen and bathroom repair adhesive and sealant for fitting accessories such as soap holders. ARDEX CA 20 P is shrinkage free and can be used to fill movement joints. Use on interior or exterior walls and floors. Ideal for bonding most construction materials.



10.5 OZ



# GROUT

**LAKESIDE**

Misty Blue 50*
Glacier Ice 41
Raw Steel 44
Slate Gray 21
Gunmetal 45*
Charcoal Dust 23*
Azure Blue 27

**URBAN**

Sugar Cookie 03
Dove Gray 18
Stone Beach 13*
Silver Shimmer 19*
Dark Walnut 48
Cast Iron 22
Black Licorice 24*

**SUMMIT**

Brilliant White 35
Polar White 01*
Fresh Lily 02
Irish Crème 10
Smoke 42
Battleship 43*
Stormy Mist 25

**SHORE**

Natural Bone 36
Antique Ivory 04*
Natural Almond 09
Vintage Linen 08
Mocha Latte 40
Apple Butter 46
Ground Cocoa 16

**CANYON**

Desert Sand 37
Sahara Drift 38*
Caraway 39*
Kodiak Brown 47
Coffee Bean 17
Gray Dusk 15
Molasses 49
Baked Terra Cotta 32

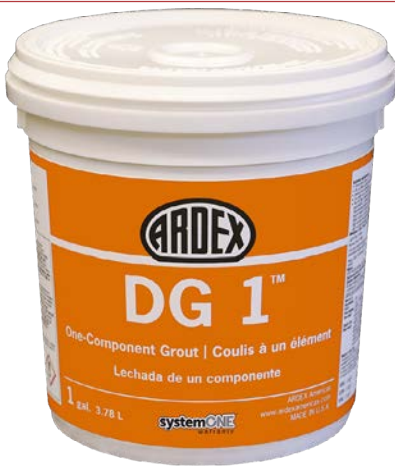

*Antique Ivory  
Battleship  
Black Licorice  
Caraway  
Charcoal Dust  
Gunmetal  
Misty Blue  
Polar White  
Sahara Drift  
Silver Shimmer  
Stone Beach  
Fresh Lily  
Sugar Cookie  
Irish Creme  
Vintage Linen*

1 GAL

## ARDEX DG 1™

Vendor Item #DG 1

### One-Component Grout

- Ready to use; can be used straight from pail with no additional water
- For use in both commercial and residential applications
- Use with porcelain, glass, quarry, ceramic and most natural stone (moisture insensitive) tiles
- Stain resistant, water repellent and highly flexible
- Use for grout joints from 1/16" to 1/2" (1.5 mm to 12.7 mm)
- Efflorescence free and crack resistant
- Mold and mildew resistant
- No sealer required
- Thicker formula for easier vertical applications straight from the pail; no need to add water

## ARDEX FH™

Vendor Item #FH- Style #AR-FH

### Sanded Floor and Wall Grout

- Use with porcelain, glass, quarry, ceramic and most natural stone tiles\*
- For grout joints 1/16" to 3/4" (1.5 mm to 19 mm)
- Very easy to apply and clean
- Interior and exterior floor and wall applications
- Available in 36 colors

*ARDEX FH™ Sanded Floor and Wall Grout is an ideal, everyday, Portland cement-based, polymer-modified grout suitable for most sizes of floor and wall tiles, including mosaics, with grout joints from 1/16" to 3/4" (1.5 mm to 19 mm). When mixed with water, ARDEX FH is a creamy, easily applied grout with good joint filling properties, enabling deep joints to be filled in one operation. When cured, ARDEX FH is weather resistant, unaffected by water and is suitable for internal and external use in dry or wet conditions.*



25LBS/ ALSO AVAILABLE IN 10 LBS

# ARDEX FG-C™

Vendor Item #FG-C- Style #AR-FG

## MICROTEC® Unsanded Grout

- Creamy consistency provides fuller grout joints and an ultra-smooth finish
- Excellent color consistency
- Water and stain resistant, no sealing required
- Use with porcelain, glass, quarry, ceramic, mosaic and most natural stone tiles
- For joints up to 1/4" (6 mm); porcelain tile joints up to 1/8" (3 mm)
- For interior or exterior applications - floors, walls and showers
- Open to traffic in just 4 hours
- Easy to mix and apply- No slake time required
- Naturally resistant to mold and mildew- Antimicrobial protection
- High strength; resists cracking

**ARDEX FG-C™ MICROTEC® Unsanded Floor & Wall Grout is a high-performance, Portland cement-based, unsanded grout that delivers fuller, more aesthetically pleasing grout joints with an ultra-smooth finish for floor and wall tile joints up to 1/4" (6 mm) or porcelain tile joints up to 1/8" (3 mm). Use for installations of porcelain, glass, quarry, ceramic and mosaic tile, as well as most natural stone tiles. ARDEX FG-C is freeze/thaw stable, naturally resistant to mold and mildew formation and can be open to traffic in just 4 hours. Ideal for interior and exterior floors, walls, countertops and showers.**



25 LBS



**ARDEX FL™ Rapid Set, Flexible, Sanded Grout is a high-performance, Portland cement-based, polymer-modified grout that provides a smooth finish for floor and wall tile joints 1/16" to 1/2" (1.5 mm to 12.7 mm) wide on installations of porcelain, glass, quarry, ceramic, mosaic and most natural stone tiles. Freeze/thaw resistant, stain resistant, water repellent and naturally resistant to mold and mildew formation. Fast setting and can be open to traffic in just 90 minutes. Ideal for interior and exterior floor and wall applications, as well as for use in swimming pools and other wet areas with pH-balanced water.**

25 LBS

# ARDEX FL™

Vendor Item #FL- Style #AR-GRO

## Rapid Set, Flexible, Sanded Grout

- Rapid set - open to traffic in just 90 minutes, submerged applications in 72hrs.
- Excellent color consistency
- Unique, easy-to-use consistency, easy to mix and apply - just add water
- Stain resistant, water repellent and highly flexible
- Use for grout joints from 1/16" to 1/2" (1.5 mm to 12.7 mm)
- Use with porcelain, glass, quarry, ceramic and mosaic tile as well as most natural stone tiles
- Ideal for commercial and residential applications including swimming pools, showers and kitchens
- Mold and mildew resistant, no sealer required
- Use for interior or exterior applications - floors and walls

# ARDEX WA™

Vendor Item #WA

## High Performance, 100% Solids Epoxy Grout & Adhesive

- Grout joints up to 1/2" (12 mm) wide
- Use where maximum chemical resistance and/or hygiene and cleanliness are required
- Use for applications in food processing, industrial, institutional and commercial facilities
- Ideal for swimming pools, hot tubs and other wet areas, can be submerged after only 7 days
- Very easy to clean with only water
- Use for interior and exterior floors and walls
- Waterproof and frost resistant
- Solvent free, low VOC's

**ARDEX WA™ High-performance, 100% Solids Epoxy Grout and Adhesive is a solvent-free, two-component epoxy grout and adhesive. ARDEX WA is suited particularly for tile installations in industrial areas, swimming pools, hot tubs, showers, bathrooms, dairies, meat packing facilities, breweries, hospitals and any installation requiring high standards of hygiene and chemical resistance. Tile installed with ARDEX WA can be grouted in 12 hours. Available in 36 colors.**



6.6 LBS





# UNCOUPLING & HEAT MEMBRANES



**ARDEX UI 740™ FLEXBONE® Uncoupling Membrane** is a high load-bearing uncoupling membrane ideal for large format tile in high traffic areas. The unique bone-shaped pattern with GripLock Technology delivers outstanding tensile bond strength. The system helps neutralize underlying substrate movement and supports and distributes heavy loads from above. Special high-performance felt helps provide vapor equalization. ARDEX UI 740 FLEXBONE can be used as a waterproof layer in bathrooms and wet areas.

3'3 X 65'6 215 SQ FT PER ROLL

## ARDEX UI 740 FLEXBONE™

Vendor Item #UI 740- Style #AR-UNC UI-740

### Uncoupling Membrane

- PRODUCT ENHANCEMENT: Now with added ventilation channels
- Prefill with just one pass
- High load-bearing uncoupling membrane
- Ideal for large format tile and stone in heavy traffic areas
- For use with porcelain, ceramic, quarry and natural stone tiles
- Helps prevent grout joint and tile damage from substrate movement
- Suitable as a waterproofing membrane
- For use in high stress areas, such as shopping malls, airports, office buildings, hospitals, etc.
- For use over wooden or concrete substrates
- Can be prefilled with ARDEX Liquid BackerBoard® Self-Leveling Underlayment

## ARDEX UH 900 FLEXBONE™

Vendor Item #UH 900- Style #AR-HEA UH-900

### In-Floor Heating Systems, 3-in-1 Membrane

- 3-in-1 In-Floor Heating, Uncoupling and Waterproofing
- Uncoupling: protects tile and grout joints from shear movement in the substrate
- Waterproofing: for use in bathrooms, laundry rooms and other wet areas
- Maximum heat efficiency, more heat comfort with less energy usage
- Minimal roll memory - rolls out flat every time!
- High quality heating cables - more efficient, easier to install, less cable required
- Ideal for large-format tile and stone installations
- FLEXBONE® Effect: prefill with mortar in just one pass
- ARDEX Self-Leveling Underlayments; prefill option that fully encases cables
- Single-Source, Complete System Solution
- 10-Year system warranty

**ARDEX FLEXBONE® HEAT** is an electrical in-floor heating system for use with tile or stone. The unique crossbones pattern provides less touch points between the cables and the membrane, and less air space within the mat structure, providing faster and more efficient heating of the floor covering. The unique design also allows for easy prefilling in just one pass with ARDEX high-performance mortars, or approved ARDEX Self-Leveling Underlayments can be used for easier, faster prefilling to fully encase the heat cables. ARDEX FLEXBONE® HEAT can be used as a waterproofing layer in bathrooms and other wet areas. Ideal for large-format tile and stone installations, ARDEX FLEXBONE® HEAT is also an uncoupling membrane that helps to prevent grout joint and tile damage from underlying substrate movements.



133.25 SQ FT/ROLL

# THERMOSTATS & POWER MODULES

## FLEXBONE™ REMOTE WIFI TOUCH THERMOSTAT

Vendor Item #UH 930- Style #AR-HEA TH-WIFI

- Complete system control from anywhere via smartphone app or desktop computer
- Automatically track and log power consumption
- Easy to use Set-Up Wizard



1 UNIT

## FLEXBONE™ HEAT TOUCH PROGRAMMABLE

Vendor Item #UH 931- Style #AR-HEA TH-P

- 3.5" touch display
- Easy to use Set-Up Wizard
- Ability to track and log power consumption



1 UNIT

## FLEXBONE™ HEAT NON-PROGRAMMABLE

Vendor Item #UH 932- Style #AR-HEA TH-NONP

- Easy to read, digital display
- Straight forward on/off control



1 UNIT

## FLEXBONE™ POWER MODULE

Vendor Item #UH 940- Style #AR-HEA PO-MOD

- Extends power output by 15 amps for both 120V and 240V cables
- Easily connects to any ARDEX FLEXBONE® HEAT Thermostat



1 UNIT



# SHOWER SYSTEMS

## TLT™ CURBS

Vendor Item #TLT

The ready-to-install, pre-waterproof ARDEX TLT™ curb is made of a lightweight foam, and is manufactured out of the same foam as the ARDEX TLT™ Building Panels, with a proprietary blend of synthetic polymer mortar and an alkali resistant fiber mesh, making these curbs strong and durable. Designed to integrate with ARDEX TLT™ Shower Systems, ARDEX TLT Curb is load-bearing and heavy-duty, and can be tiled upon to create a completely waterproof design. If a longer curb is required, combine and join multiple pieces with ARDEX TLT™ Seam Tape and ARDEX TLT™ Waterproofing Membrane. If a shorter curb is required, simply cut this curb down with a sharp razor blade knife.

- Pre-waterproof
- Lightweight
- Two sizes available
- Easy to cut to required size
- Ready-to-install
- Load-bearing & heavy-duty



TLT™ 601 4.5" x 3" x 48"  
 TLT™ 602 4.5" x 3" x 60"  
 TLT™ 603 4.5" x 3" x 72"

1 UNITS /CTN ? CTNS/PLT

## TLT™ DRAIN KITS

Vendor Item #TLT



Brushed Nickel



Brushed Bronze



Matte Black



Chrome

ARDEX TLT™ Drain Kits are made from SAE 304 stainless steel, one of the most common and widely used stainless steel types because of the ease in which it is formed into various shapes. These drain kits are electroplated, a method used to give each drain the desired color and finish. Kit includes 1 4" drain grate, 1 adjustable drain adapter and 1 Connectite® assembly and instructions. Pictured are square punch, but also available in linear slit, diamond punch and tileable.

- SAE 304 stainless steel
- Higher corrosion resistance
- Multiple styles & colors available

1 UNITS /CTN ? CTNS/PLT



# TLT™ SHOWER BASES

## Vendor Item #TLT

Center Drain Base	Dimensions	Offset Drain Base	Dimensions	Custom Drain	Dimensions
ARDEX TLT™ 201	32" x 60"	ARDEX TLT™ 202	32" x 60"	ARDEX TLT™ 901	< 32" x 60"
ARDEX TLT™ 203	36" x 48"	ARDEX TLT™ 205	36" x 60"	ARDEX TLT™ 903	< 36" x 48"
ARDEX TLT™ 204	36" x 60"			ARDEX TLT™ 904	< 36" x 48"
ARDEX TLT™ 206	48" x 48"			ARDEX TLT™ 906	< 48" x 48"
ARDEX TLT™ 207	48" x 72"			ARDEX TLT™ 907	< 48" x 72"
ARDEX TLT™ 208	72" x 72"			ARDEX TLT™ 908	< 72" x 72"

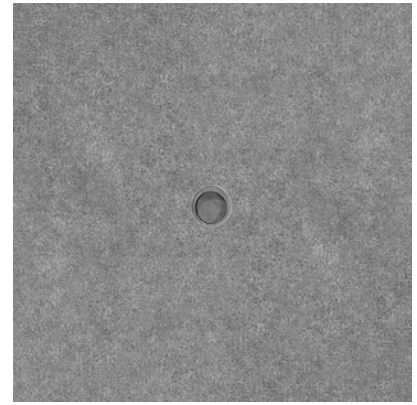

*An all-in-one solution that installs easily, quickly and securely with all system components perfectly adapting to each other. Pre-sloped, Waterproofed and built in drain assembly included. Easily cut down or extend.*

1 UNITS /CTN ? CTNS/PLT

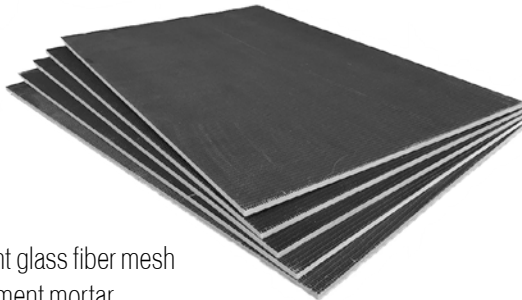

- Alkali-resistant glass fiber mesh
- Polymeric cement mortar
- XPS Foam
- Approved for steam showers via ASTM E 96-05 when Waterproofing Membrane is installed over the Building Panels

1 UNITS /CTN ? CTNS/PLT

# TLT™ BUILDING PANELS

## Vendor Item #TLT

TLT™ 102	3' x 5' x 1/4"	TLT™ 108	2' x 8' x 1 1/4"
TLT™ 103	3' x 5' x 1/2"	TLT™ 109	2' x 8' x 1 1/2"
TLT™ 110	2' x 8' x 2"	TLT™ 111	2' x 8' x 3 1/5"
TLT™ 114	4' x 5' x 1/2"	TLT™ 112	2' x 8' x 3 9/10"
TLT™ 115	4' x 8' x 1/2"	TLT™ 113	3' x 8' x 1/2"
TLT™ 116	4' x 8' x 2"	TLT™ 117	32" x 48" x 1/8"
TLT™ 101	2' x 4' x 1/8"	TLT™ 118	32" x 48" x 1/4"
TLT™ 105	3' x 5' x 5/8"	TLT™ 119	32" x 48" x 1/2"
TLT™ 106	2' x 8' x 3/4"	TLT™ 121	32" x 48" x 5/8"
TLT™ 107	2' x 8' x 1"	TLT™ 122	2' x 4' x 2"

# TLT™ NICHE

## Vendor Item #TLT

*The ARDEX TLT™ Niche is a thin, ultra-lightweight, waterproof proprietary blend of synthetic polymer mortar and an alkali-resistant fiber mesh.*

- Pre-waterproof
- Lightweight
- Vapor-resistant
- Multiple sizes available
- Easily move shelf up or down for custom usage
- Easy to install & ready for tile
- For use with any wall tile shower system

NICHE #	DIMENSIONS
TLT™ 501	16" x 16"
TLT™ 502	16" x 22"
TLT™ 503	16" x 28"



1 UNITS /CTN ? CTNS/PLT

# DESIGNER SURFACES



ARDEX Surfaces allow for a wide array of finished surfaces that install fast thanks to an exclusive self-drying technology, and last for decades. ARDEX Surfaces are flooring toppings that range from turn-key pour and seal to designer or artistic floors that can match any designer's vision. When you install ARDEX Surfaces, you'll have a beautiful, durable floor for years to come.

## ARDEX PC-T™

Vendor Item #PC-T

### Polished Concrete Topping



- Smooth concrete & non-porous surfaces
- Install from 3/8" up to 2" neat and up to 5" with aggregate
- Walkable in 2-3 hours
- Polish in as little as 24 hours
- Use with the ARDEX APCS

50 LBS

## ARDEX SD-T™

Vendor Item #SD-T

### Self-Drying Self-Leveling Concrete Topping

- Smooth concrete & non-porous surfaces
- Install from 1/4" up to 2" neat, and up to 5" with aggregate
- Walk on and seal in 2 hrs
- For commercial, light industrial & residential applications
- White or Gray

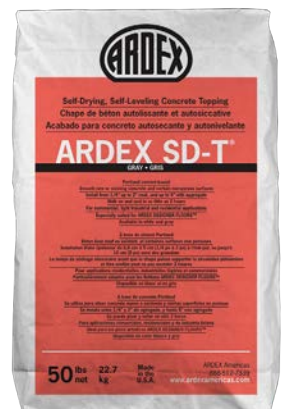

50 LBS

### PREMIUM TOPPINGS

# ARDEX K 521™

Vendor Item #K 521

## Self-Leveling Concrete Topping with Aggregate Surface

ARDEX K 521™ is a pourable, polishable, self-leveling topping for fast-track resurfacing of indoor concrete. ARDEX K 521 can be installed from a minimum thickness of 3/8" (9 mm) up to a maximum thickness of 2" (5 cm). Use ARDEX K 521 to provide a polished, "aggregate-exposed" surface. Polishing can proceed in as little as 24 hours.



- Resurface indoor concrete
- Walk on in 2-3 hours
- Polish in as little as 24 hours
- Dual Water Ratio
- Use for interior floors only



POUR & POLISH

50 LBS

# ARDEX K 523™

Vendor Item #K 523

## Self-Leveling Concrete Topping with Aggregate Surface

ARDEX K 523™ is a pourable, polishable, self-leveling topping for fast-track resurfacing of indoor concrete. ARDEX K 523 can be installed from a minimum thickness of 3/8" (9 mm) up to a maximum thickness of 2" (5 cm). With black and white aggregates, ARDEX K 523 provides a polished, "aggregate-exposed" surface. Polishing can proceed in as little as 24 hours.



- Resurface indoor concrete
- Walk on in 2-3 hours
- Polish in as little as 24 hours
- Use for interior floors only

POUR & POLISH

50 LBS



# ARDEX K 520™

Vendor Item #K 520

## Self-Leveling Concrete Topping

- Resurface Interior concrete
- Walk on in 2-3 hrs
- Seal or polish in 24 hrs
- Installs up to 1" neat



POUR & SEAL, POUR & POLISH

50 LBS

# ARDEX K 530™

Vendor Item #K 530

## Decorative Concrete Topping

- Resurface Interior concrete
- Walk on in 2-3 hrs
- Seal or polish in 24 hrs
- Use as a binder
- Natural White



50 LBS





***LINT TILE***

111 NOTCH LANE WENDEL, PA 15691  
P: 800-245-5564 F: 724-446-9252  
[www.linttile.com](http://www.linttile.com)